

Doc 1

REASONS FOR APPLICATION:

The tree, a large-leaved oak, is located 4.9 metres from the house, on an elevated bank, close enough for its branches to overhang part of the roof.

There is a pathway, which connects the driveway to the back door. Half way along this path are steps up and the down, a result of reconstructing the house some centuries ago. So one must climb up then down to reach the door.

After leaf fall, the path, steps and bank above get completely covered by leaves. This makes the journey very dangerous, as one can easily slip on the leaves. I have cleared the leaves, only to find that after the next windy day, more leaves have blown down from the bank above.

Apart from the danger, the tree causes all the white paintwork on the windows to grow a green mould, which penetrates the paint. We recently had a window company visit, and they strongly recommended the removal of the tree for that reason.

The tree also cuts out a lot of daylight from that side of the house.

Those are the main reasons for requesting the tree be completely felled.

P\*\* May I add that we love trees, continuing to add to our growing collection of native and specimen trees, of which there must now be about 50 or more. It's just this one, which has unfortunately been allowed to grow in the wrong location.

PHOTO – Turn 90°



P.T.O ...

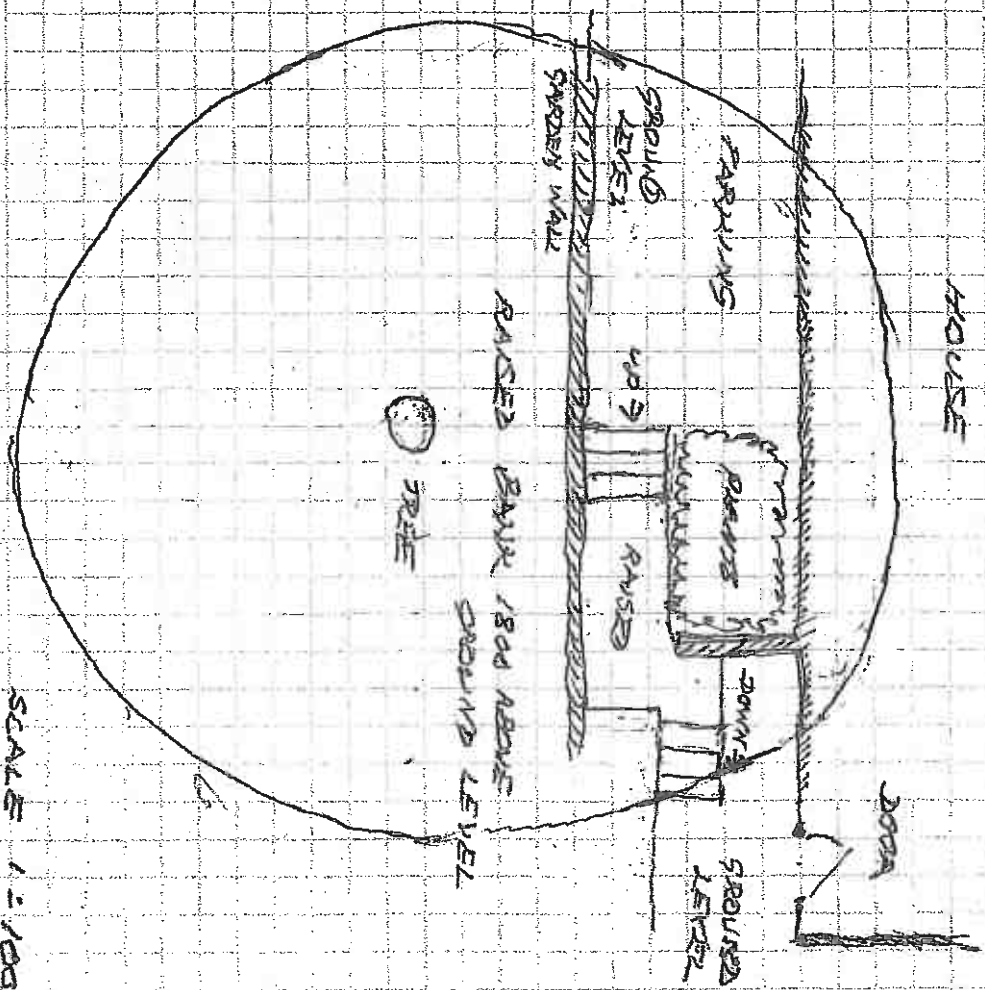

SCALE 1:100